

MISCELLANEOUS

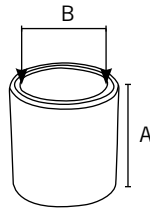



BUSH



CORNALL

STEEL REDUCING BUSH

- 17-4 taper down to 17-26 taper
- raw finish

CODE	A	B	Pack Size
174-1726 *	29	22	200

* indent item only



BUSH

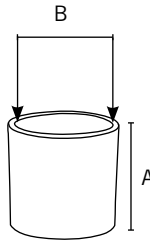

CORNALL

STEEL TAPERED BUSH

- 50.8mm diameter
- raw finish

CODE	A	B	Pack Size
150-20 *	55	50	50

* indent item only



BUSH

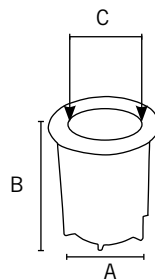

CORNALL

NYLON REDUCING BUSHES

- suits 50mm diameter
- 25.4mm and 32mm diameter centre hole
- black finish

CODES	A	B	C	Pack Size
603.50108.002	57	65	25.4	1000
603.50308.002 *	57	65	32	1000

* min 3000



SPACER

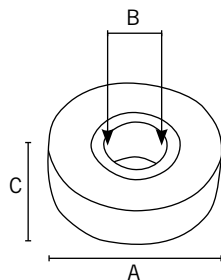

CORNALL

SPACERS

Z series

- nylon
- 19mm diameter
- black finish

818 series

- plastic
- 28mm diameter
- black finish

CODES	A	B	C	Pack Size
Z181X1/4BL	19	6.4	6.5	1000
Z181X3/8BL	19	9.6	6.5	1000
818.04102.002	28	10	5	1000
818.04112.002	28	10	9	1000
818.04122.002	28	10	12	1000
818.04132.002	28	10	14	1000



SCREW TRUSS HEAD

- M6 threaded screws
- serrated under head
- black oxide finish

CODES	A	B	C	Pack Size
321.30016.331	13	16	M6	10000
321.30020.331	13	20	M6	8000
321.30025.331	13	25	M6	6000
321.30030.331	13	30	M6	4800
321.30035.331	13	35	M6	2600
321.30040.331	13	40	M6	2500
321.30045.331	13	45	M6	2500

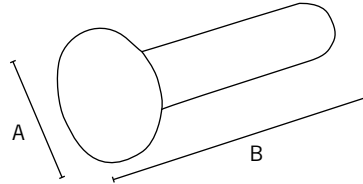

FASTENER



STEEL TEE NUT

- 4 prong
- raw, zinc and stainless steel finish

CODES	A	B	C	Pack Size
300.05506.330 *	25	6	M5	10000
300.05609.330	30	9	M6	5000
300.05609.352	30	9	M6	5000
300.06611.330	30	11	M6	5000

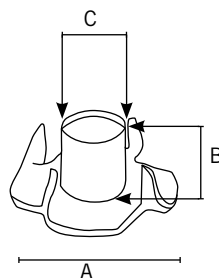

FASTENER



STAPLES

- galvanized wire
- natural finish

CODES	A	B	C	Pack Size
A10007 (806)	6	12.9	.84	20000
A10009 (808)	8	12.9	.84	20000
A10011 (810)	10	12.9	.84	20000
A10013 (812)	12	12.9	.84	10000
A10015 (814)	14	12.9	.84	10000

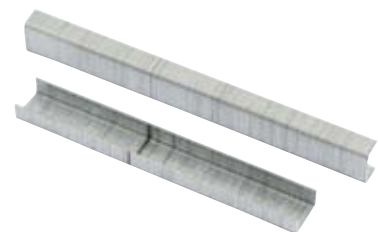
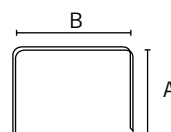



CONNECTOR

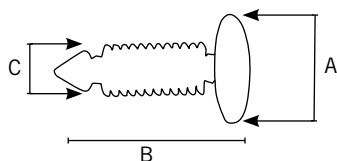

CHRISTMAS TREE

- single end with 12mm, 16mm, 20mm diameter flat head
- natural finish

CODES	A	B	C	Pack Size
216.00060.002	16	27	7.5	5000
216.00070.002	20	27	7.5	4000
216.00150.002	20	15	6.8	6000
216.00190.002	12	36	6.8	7500



CONNECTOR

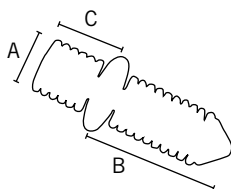

CHRISTMAS TREE

- double end with 1.2mm diameter
- natural finish

CODE	A	B	C	Pack Size
216.00640.000	1.2	22	2.2	4000



CONNECTOR

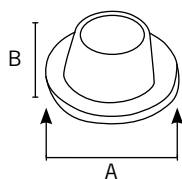

UPHOLSTERY

- 2 piece nylon clip together
- black finish

CODE	A	B	Pack Size
755.30010.002	40	26	1000



CONNECTOR

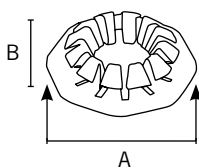

UPHOLSTERY

- 2 piece nylon fast clip and nut
- black finish

CODE	A	B	Pack Size
755.40000.002	40	26	1000

GLIDE



SADDLE GLIDE

- nylon
- 1/2" - 5/8" round tube
- black finish
- plastic
- 3/4" - 7/8" diameter
- black finish

CODE	A	B	Pack Size
N2015-1/2X5/8BL	18	25	1000
P2015-3/4X7/8BL *	18	25	1000

* indent item only
(min 4000)

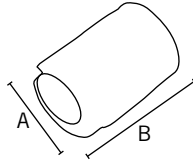

CORNALL

GLIDE



STEM BUMPER

- nylon
- 7/8", 1", and 1 1/4" round tube
- black finish

CODES	Tube	B	Pack Size
N764X7/8BL	22	6.4	1000
N764X1BL	25	6.4	1000
N764X11/4BL	32	5	1000



CORNALL

GLIDE



STEM BUMPER

- plastic
- 10mm diameter base
- 6.35mm diameter x 12mm long
- clear finish

CODE	A	B	Pack Size
P795X10-3C	10	6	5000

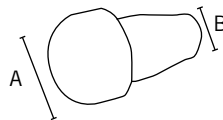

CORNALL

* black version pictured

GLIDE



STEM BUMPER

- nylon
- 10mm, 13mm and 19mm diameter base
- 6.35mm diameter x 12mm long
- black finish

CODES	A	B	Pack Size
N795X10BL	10	6	5000
N795X13BL	13	6	5000
N795X3/4BL	19	6	1000

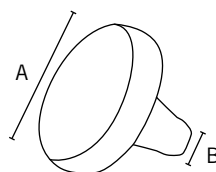

CORNALL



TUBE CLOSURE

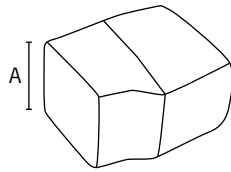

TUBE GLIDE

- nylon
- angled 18 degrees
- suits 1" square tube
- black finish

CODE	A	Pack Size
N186X1BL	1"	400



TUBE CLOSURE

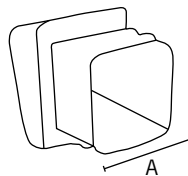

ANGLED

- nylon
- angled 18 degrees
- grip square
- 3/4" x 1.6mm wall
- black finish

CODE	A	Gauge (mm)	Pack Size
N772X3/4BL	3/4"	1.2-1.6	1000

CORNALL



TUBE CLOSURE

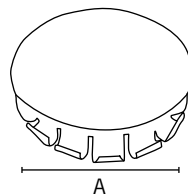

ROUND METAL

- domed metal closure
- nickel plate and raw finish

CODES	A	Gauge (mm)	Pack Size
P274X5/8NP	5/8"	1.6	7000
P274X3/4NP	3/4"	1.6	4335
P274X3/4RAW	3/4"	1.6	2800
P274X7/8NP	7/8"	1.6	1000
P274X1NP	1"	1.6	1000
P274X1RAW	1"	1.6	3450
P274X11/4NP	1 1/4"	1.6	2600
P274X11/4RAW	1 1/4"	1.6	1335
P274X11/2NP	1 1/2"	1.6	2000
P274X11/2RAW	1 1/2"	1.6	2000
P274X2RAW	2"	1.6	1500

TUBE CLOSURE



ROUND

- plastic
- round tube closure
- black and white finish

CODES	A	Gauge (mm)	Pack Size
P769X1/2BL	1/2"	1.2-1.6	1000
P769X5/8.002	5/8"	1.2-1.6	1000
P769X5/8.001	5/8"	1.2-1.6	1000
P769X3/4BL	3/4"	1.2-1.6	1000
P769X3/4W	3/4"	1.2-1.6	1000
P769X1BL	1"	1.2-1.6	1000
P769X1W	1"	1.2-1.6	1000
P769X1X2BL	1"	2	1000
P769X11/8BL	1 1/8"	1.2-1.6	1000
P769X30BL	1 1/8"	1.2-1.6	1000
P769X11/4BL	1 1/4"	1.2-1.6	1000

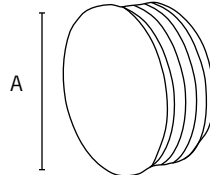

CORNALL

TUBE CLOSURE



ROUND

- plastic
- round tube closure
- black finish

CODES	A	Gauge (mm)	Pack Size
P778X35BL **	35	1.2	1000
P778X11/2BL	1 1/2"	1.6	1000
P778X40BL	40	1.6	1000
P778X13/4BL *	1 3/4"	1.6	500
P778X50BL	50	1.6	500
P778X2BL	2"	1.6	400
P778X21/2BL	2 1/2"	1.6	300
P778X3BL	3"	1.6	500
P778X75BL ***	75	1.6	500

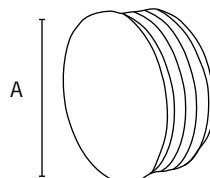

CORNALL

- * (min 2000)
- ** (min 6000)
- *** (min 4000)

TUBE CLOSURE



ROUND DOMED

- plastic
- domed tube closure
- 3/4", 7/8", and 1" diameter x 1.6mm wall
- black finish

CODES	A	Gauge (mm)	Pack Size
P769DX3/4BL	3/4"	1.2-1.6	1000
P769DX7/8BL	7/8"	1.2-1.6	1000
P769DX1BL	1"	1.2-1.6	1000

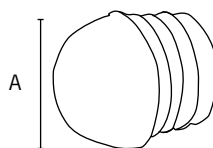

artia
Specialists In Cabinet and Furniture Hardware

CORNALL



TUBE CLOSURE



CORNALL

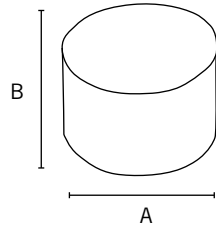

EXTERNAL CAP

- plastic
- black and white finish

CODES	A	B	Pack Size
P803X10W	10	16	1000
P803X5/8BL	5/8"	19	1000
P803X5/8W	5/8"	19	1000
P803X3/4BL	3/4"	25	1000
P803X1BL	1"	28	1000
P803X1W	1"	28	1000
P803X11/4BL	1 1/4"	32	1000



TUBE CLOSURE



CORNALL

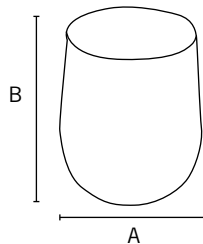

EXTERNAL CAP DOMED

- plastic
- heavy duty
- 5/8", 3/4", 7/8" and 1" diameter
- black and white finish

CODES	A	B	Pack Size
P785X5/8BL	5/8"	32	1000
P785X3/4BL	3/4"	35	1000
P785X7/8BL	7/8"	38	1000
P785X1BL	1"	42	500
P785X1W	1"	42	500



TUBE CLOSURE

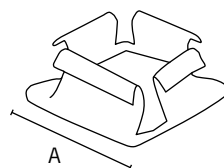

SQUARE METAL

- flat top metal closure
- nickel plate finish

CODES	A	Gauge (mm)	Pack Size
P275X3/4NP	3/4"	1.6	2000
P275X1NP	1"	1.6	2000

TUBE CLOSURE



SQUARE

- plastic square cap
- black and white finish

CODES	A	Gauge (mm)	Pack Size
P780X1/2BL	1/2"	1.6	1000
P780X5/8BL	5/8"	1.6	1000
P780X3/4BL	3/4"	1.6	1000
P780X3/4W	3/4"	1.6	1000
P780X20BL	20	1.6	1000
P780X7/8BL	7/8"	1.6	1000
P780X1BL	1"	1.6	1000
P780X1W	1"	1.6	1000
P780X11/4BL	1 1/4"	1.6	1000
P780X30BL	30	1.6	1000
P780X35BL	35	1.6	1000
P780X11/2BL *	1 1/2"	1.6	500
P780X40BL	40	1.6	500

* (min 8000)



CORNALL

TUBE CLOSURE



SQUARE

- round cornered square cap
- plastic
- 2" diameter x 3.2mm wall
- black finish

CODE	A	Gauge (mm)	Pack Size
P780RX2BL	2"	3.2	300

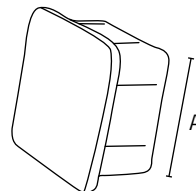

CORNALL

TUBE CLOSURE



SQUARE

- square cornered square cap
- plastic
- 2" diameter x 1.6mm wall
- black finish

CODE	A	Gauge (mm)	Pack Size
P780SX2BL	2"	1.2-1.6	300

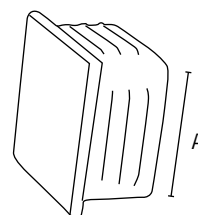

CORNALL



TUBE CLOSURE

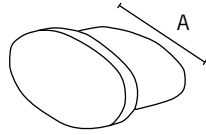

CORNALL

OVAL

- nylon
- 1 1/4" (31.8mm) x 1 1/16" (17.5mm) x 1.6mm wall
- black finish

CODE	A	Gauge (mm)	Pack Size
N2004BL	1 1/4"	1.6	1000



TUBE CLOSURE

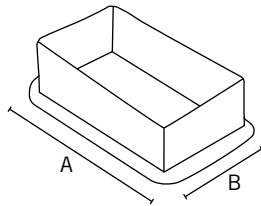

CORNALL

RECTANGULAR

- plastic
- 1.6mm gauge
- black finish

CODES	A	B	Pack Size
P1475BL	1 1/2"	1"	500
P2019BL	50	20	1000

- plastic
- 2mm gauge
- black finish

CODE	A	B	Pack Size
P2020BL	65	35	500